

GENERAL SPECIFICATIONS

• Overall Length (L.O.A)	10,77 m	35'4"
• Hull length	9,96 m	32'8"
• L.W.L.	9,50 m	31'2"
• Hull Beam	3,57 m	11'9"
• Deep draft (Cast iron)	2,00 m	6'7"
• Deep ballast weight	1 580 kg	3,482 lbs
• Shallow draft (Cast iron)	1,50 m	4'11"
• Shallow ballast weight	1 860 kg	4,099 lbs
• Performance draft (Hydraulic retractable keel)	1,25 - 2,550 m	4'1" - 8'4"
• Ballast weight performance	1 506 kg	3,319 lbs
• Air draft (all masts), with aerial	15,57 m	51'1"
• Light displacement	5 470 kg	12,046 lbs
• Fuel tank capacity (standard)	130 L	34 US Gal
• Fresh water capacity:		
- standard	231 L	61 US Gal
- Option	130 L	34 US Gal
• Engine power		
- standard	21 HP	21 HP
- Option	30 HP	30 HP

ARCHITECTS / DESIGNERS

- Naval Architect: Marc Lombard
- Outside & interior design: Nauta Design

EC CERTIFICATION

- Category A - 6 people
- Category B - 8 people
- Category C - 10 people

STANDARD SAILS DIMENSIONS

• Classic mainsail (standard)	31,40 m ²	338 sq ft
• Furling mainsail (Option)	26,20 m ²	282 sq ft
• Self-tacking jib (standard)	17,10 m ²	184 sq ft
• Furling genoa (106 %)	23,30 m ²	251 sq ft
• Code 0	50,40 m ²	542 sq ft
• Asymmetrical spinnaker	80,00 m ²	861 sq ft
• Classic mast:		
- I	12,82 m	42'1"
- J	3,65 m	12'
- P	12,66 m	41'6"
- E	4,15 m	13'7"
• Roller furling mast:		
- I	12,79 m	42'
- J	3,65 m	12'
- P	12,56 m	41'2"
- E	4,50 m	14'9"

PERFORMANCE SAILS (Requires standard classical mast)

• Square top mainsail	35,30 m ²	380 sq ft
• Genoa (on Flatdeck furler)	27 m ²	290 sq ft

seawapps

CONNECT YOUR BOAT FREE YOUR MIND

STANDARD EQUIPMENT

CONSTRUCTION

- Design made following European Directive requirements and according to CE certification
- Monolithic hull in polyester
- Monolithic structural hull liner bonded to the hull
- Fibreglass and balsa wood sandwich contact deck, with diamond pattern non-slip coating
- Hull-deck joint screwed, bonded and trimmed with 1 toerail
- Cast iron keel fixed with bolts and stainless steel backing plates
- 2 Underhung rudders with stainless steel stock
- White hull - Grey metal hull decoration

DECK EQUIPMENT

RIGGING

- Standard mast $\frac{9}{10}$ anodized aluminum deck stepped, 2 aft-swept spreaders - Without backstay (Selden) - Without backstay
- Anodized aluminum boom
- Discontinuous stainless steel standing rigging
- Rigid boom vang
- Self-tacking jib rigging with on-deck furler
- Mainsail stay rope on the roof (with 2 chainplates)
- 1 Self-tacking jib track with traveller
- Complete running rigging: Main halyard, Genoa halyard with cleat on mast, Boom topping lift with cleat on mast, Mainsheet, 1 Self-tacking jib sheet
- 8 Clutches
- 2 Flag halyards

WINCHES

- 1 Self-tailing winch (H35.2 STA) to port, on the roof
- 1 Aluminum winch handle
- 1 Winch handle holder

SAILS (Sail technology)

- Classic Dacron C-breeze mainsail with Natural UV protection, cross cut, semi full batten
- Self-tacking jib Dacron C-breeze with UV protection Natural, horizontal cut

MOORING - ANCHORING GEAR

- Self-draining chain locker - Clench bolt - Hatch cover
- Single bow roller
- 6 Aluminum mooring cleats - Stainless steel chafing plate

SAFETY ON DECK

- Stainless steel pulpit 2 sections
- 2 Stainless steel aft pushpits
- 1 Ring lifebuoy bracket
- Double life lines and stainless steel stanchions
- Welded ring on pushpit for flag
- Emergency ladder on pushpit

COCKPIT

- Self-bailing cockpit
- 1 Cockpit locker under port side bench
- 2 Lockers in cockpit bottom
- Side helm seats (aft helm seats in trim)
- 1 Liferaft locker to aft of cockpit (Usable dimensions: 800 mm x 505 mm x 370 mm / 2'7" x 1'8" x 1'3")
- Iro-Deck slatted cockpit benches (1,56 m x 0,50 m / 5'1" x 1'8")
- Polyester drop-leaf cockpit table, Stainless steel handrail
- Tilling positon: Stainless steel steering wheels - 800 mm diameter / 2'7" - Leather covered - Steering gear at the helm station - Steering line transmission system - Stainless steel handrail - 1 Cup holder
- 1 Steering compass to starboard of the companionway
- 2 Deck access points to tiller system
- 1 Emergency tiller
- Engine throttle and control panel on starboard
- 2 Hinged PMMA companionway doors - Sliding hatch made of PMMA
- 1 Fixed, telescopic stainless steel swimming ladder

SWIM PLATFORM / AFT TRANSOM (in trim level)

- Fully opening transom, convertible into swim platform (2,35 m x 0,70 m / 7'9" x 2'4")
- Manual opening using hoist, assisted by 2 pull cylinders
- Iro-Deck slatted swim deck
- 1 Fixed, telescopic stainless steel swimming ladder

INTERIOR

- Woodwork Alpi Walnut
- Nordic Teak Parquet type laminated floorboards
- Beige padding upholstery: Salon & Cabins
- Néo 05 fabric interior upholstery
- Mattresses in the cabins, HR35kg/m³ foam

Standard version: 2 cabins + 1 head

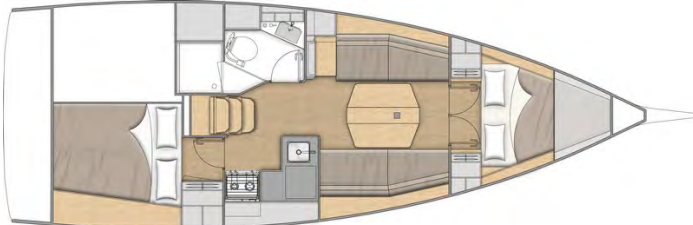

COMPANIONWAY

Headroom: 1,89 m / 6'2"

- GRP salon companionway steps are coated with non-slip surface
- 2 Stainless steel handrails covered with anthracite leather

SALON

Headroom: 1,90 - 1,85 m / 6'3" - 6'1"

- 2 Lengthways salon bench sets, can be used as a single berth: an extension cushion for the port side bench seat is stowed against the bulkhead under the chart table
- Salon table with 2 drop-leaves and 2 central top-access storage spaces. For the retractable keel version, the dimensions of the table are larger to accommodate the keel raising system
- Storage under bench seats
- 2 LED ceiling lights
- 1 USB socket on the 12V electrical panel
- 2 Panoramic roof windows
- 2 Hull portholes with curtain
- 1 Flush deck hatch with fan, T44, blind and mosquito net

STARBOARD GALLEY

L-shaped kitchen - to starboard

Headroom: 1,85 m / 6'1"

- Counter top in compact Clay with painted wooden fiddles
- 1 1 rectangular stainless steel sink (320 mm x 300 mm / 1'1" x 1')
- 1 Faucet with hot/cold water under pressure
- 1 Gas stove 2 burners - Stainless steel oven on gimbal - Stainless steel protection handrail
- Cool box 100 L / 26 US Gal top opening (Positive cold)
- Storage and lockers
- 1 Dual compartment slide-out bin (2 x 15 L / 2 x 4 US Gal)
- 1 115 V Power outlet (in trim level)
- 1 Opening porthole on coaming in the side window with mosquito net

PORT SIDE CHART TABLE

Headroom: 1,85 m / 6'1"

- Chart table with folding tray against the starboard bulkhead with shelves fitted with fiddles in the upper part
- 12 V electrical panel nearby
- 1 Adjustable LED spotlight
- 1 115 V Power outlet (in trim level)
- 1 Single USB socket
- 1 Fixed coaming window with pleated blind

OWNER'S CABIN

Headroom: 1,86 m / 6'1"

- 1 Central double bed (2,02 m x 1,60 m - 0,55 m / 6'8" x 5'3" - 1'10")
- 2 Hanging closets with 1 open shelf on top, open lockers along the hull
- 2 Adjustable LED spotlights in the headboard
- 1 dual USB port outlet on each side of the bed (in trim level)
- 1 115 V Power outlet (in trim level) - to port
- 1 Flush deck hatch with fan, T44, blind and mosquito net
- 2 Hull portholes with curtain
- Double door

STARBOARD AFT CABIN

Headroom: 1,80 m / 5'11"

- 1 Double bed (2,00 m x 1,60 m x 1,30 m / 6'7" x 5'3" x 4'3")
- 1 Hanging closet with 1 open shelf on the top
- 1 Bed access sideboard
- 2 Adjustable LED spotlights in the headboard
- 1 dual USB port (in trim level)
- 1 115 V Power outlet (in trim level)
- 1 Opening porthole on the cockpit coaming + Mosquito screens
- 1 Opening porthole below cockpit seat with curtain (Mosquito net in trim level)

AFT PORT SIDE HEAD

Access through salon

Headroom: 1,92 m / 6'4"

- Shower with plexiglass door - Self-draining storage bin - 1 Mixer tap - White polyester shower base
- 1 Manual marine toilet
- 1 80 L / 21 US Gal Rigid holding tank
- 1 Polyester basin - 1 mixing tap hot/cold water
- 1 Cabinet
- 1 Mirror
- Toilet accessories
- 1 Opening porthole in coaming
- 2 LED ceiling lights
- 1 115 V Power outlet (in trim level, except for 3 cabins 1 head version)

3 cabins 1 head version (Option)

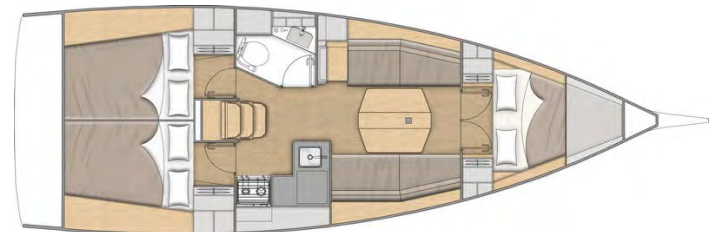

The head has a shower function mixer tap (no 115 V socket in trim level)

2 SYMMETRICAL AFT CABINS

Headroom: 1,80 m / 5'11"

- 1 Double bed (2,00 m x 1,40 m x 1,13 m / 6'7" x 4'7" x 3'8")
- 1 Hanging closet with 1 open shelf on the top
- 1 Bed access sideboard
- 2 Adjustable LED spotlights in the headboard
- 1 dual USB port (in trim level)
- 1 115 V Power outlet (in trim level)
- 1 Opening porthole on the cockpit coaming with curtain (Mosquito net in trim level)
- 1 Opening porthole below cockpit seat with curtain (Mosquito net in trim level)

ENGINE

- Engine Yanmar Diesel (Propeller shaft):
 - 21 CV/HP (standard)
 - 29 CV/HP (Option)
- Torqeedo electric engine * (Incompatible with Offshore Pack)
 - Pod Torqeedo Cruise 6.0 FP TorqLink, Fixed 5 blades propeller
 - 1 Power 48-5000 W Lithium battery
 - 1 650 W charger
 - Control on starboard console
- Engine control - Control panel in cockpit (to starboard)
- Engine compartment: Soundproofing foam - Ventilation: 2 air intakes and 1 powered air expulsion
- 1 Alternator (12 V / 125 Amp)
- 1 Rotomolded diesel tank 130 L / 34 US Gal (below aft starboard cabin berth) - Gauge on electrical panel - 1 Tank filling access
- Filters: Sea water - Diesel - Water separator
- Stainless steel shaft line
- Fixed three blade propeller
- 1 Engine access through companionway (opening with 2 gas pistons)
- 2 Access to side engine: Head & Aft cabin

*** Boat approved only for inland waterways navigation with the electric engine.**

The use of the boat is strictly limited to sailing in inland waters only (inland waters applies to rivers, canals, lakes and ponds situated inland of the low water line). In general, all calm waters, without current or chop, where the low power of the engine is sufficient to manoeuvre the boat.

ELECTRICITY

- 12 V Circuit
- 1 AGM service battery (75 Amp) - 1 AGM engine battery (50 Amp)
- 1 Load balancer
- 12 V electrical panel (Fuses - Voltmeter - 1 Fuel gauge)
- 1 Single USB socket at chart table
- LED lighting: Overhead lights, Adjustable spotlight in cabins & at chart table
- LED navigation lights: 1 Masthead light - 1 Steaming light for motoring - 1 Mooring light on masthead

PLUMBING

- 1 Rotomolded freshwater tank 206 L / 54 US Gal, under berth in forward cabin
- Electrical gauge on 12 V panel
- 1 Tank filling access
- Waterpressure system - Expansion tank - Inline filter
- 25 L / 7 US Gal Electric water heater (engine use) below salon starboard bench
- 1 80 L / 21 US Gal Rigid holding tank
- 1 Electric bilge pump - 1 Manual bilge pump
- 1 Electric shower drain pump

GAS

- Gas cylinder locker - starboard aft cockpit
- Regulator and solenoid
- Gas leak detector

SMART BOARD

"SEANAPPS" smart technology:

- For monitoring the boat's status and receiving alerts as well as maintenance advice via the associated mobile application.
- The type of information collected (GPS position, batteries, engine info, navigation data, etc.) varies according to the boat's configuration.

seanapps

CONNECT YOUR BOAT FREE YOUR MIND

MISCELLANEOUS ITEMS

- Smoke detector
- Cleaning kit: eco-friendly cleaning products kit

TRIM LEVEL & PACKS

TRIM LEVEL

	CONFORT	FAMILY
<ul style="list-style-type: none"> Slatted Iro-Deck aft platform with (manual opening) Iro-Deck slatted helm seats 1 Halyard bag (to port) Cockpit shower hot/cold water Galley: Compact sink cover with cutting board Fusion RA210 Stereo + Interior speakers & Waterproof exterior speakers Dual USB socket: in the salon (x 1), in the forward cabin (x 2), in the aft cabins (x1) Full 115 V system (6 Inside sockets, 1 Shore power socket) 1 40 Amp battery charger Battery charge display, Navicolor screen (3.5") 2 AGM service batteries - 100 Amp (instead of standard - 75 Amp) Mosquito nets for opening portholes Salon: LED indirect lighting Upgrade of hotplate/galley oven: oven with grill 	<ul style="list-style-type: none"> ■ ■ ■ ■ ■ ■ ■ ■ ■ ■ ■ ■ ■ ■ 	<ul style="list-style-type: none"> ■ ■ ■ ■ ■ ■ ■ ■ ■ ■ ■ ■ ■ ■
<ul style="list-style-type: none"> 1 000 W Electric windlass + Remote control Aft transom protection Bow stainless steel protection "Luxe" polyester drop-leaf cockpit table Outboard engine bracket Additional fresh water tank (130 L / 53 US Gal) Galley: Sea water foot pump with cool box draining function Salon & Cabins: Fans 		<ul style="list-style-type: none"> ■ ■ ■ ■ ■ ■ ■ ■ ■

ELECTRONICS PACKS: RAYMARINE

	COASTAL	OFFSHORE
<ul style="list-style-type: none"> 1 i70s display, to starboard from the companionway i70s Sensor (Log, Speedometer, Temperature) Wind Sensor (Windvane, Anemometer) Windex Windvane 	<ul style="list-style-type: none"> ■ ■ ■ ■ 	<ul style="list-style-type: none"> ■ ■ ■ ■
<ul style="list-style-type: none"> Starboard helmstation: <ul style="list-style-type: none"> 1 Steering console 1 7" Axiom + multi-function touchscreen (GPS, Chart plotter, Card reader - Navionics® + Blank cartography included) - <i>The i70s display moves to the port side</i> 1 Console cover, Cadet Grey P70s autopilot + control (to port) Chart table: RAY73 VHF, AIS receiver function 		<ul style="list-style-type: none"> ■ ■ ■ ■ ■

RIGGING PACKS (Incompatible with First Line Pack)

	DOWNWIND	UPWIND	DOWNWIND + UPWIND
<ul style="list-style-type: none"> 1 Starboard manual (H35.2 STA) rigging winch + Cadet Grey halyard bag Polyester bowsprit with integrated anchoring gear and bobstay (for Code 0 and asymmetric spinnaker) Asymmetrical spinnaker rigging / Code 0 (sheets, Blocks, Halyards) Additional jammers (on the roof for the halyard or on the coaming for the Genoa sheet, depending on the pack) Rigging run back to cockpit (except boom topping lift) 2 Manual (H40.2 STA) genoa sheet winches + Aluminum "Speed Grip" winch handle + Winch handle holder Genoa sheet 3D adjustment rings on the roof (replacing the self-tacking jib track and the traveller) Genoa sheet on furler, high resistance Dacron (to replace the standard self-tacking jib) 	<ul style="list-style-type: none"> ■ ■ ■ 1 Triple jammer, on starboard roof ■ ■ 	<ul style="list-style-type: none"> ■ ■ ■ 2 Double jammers, in coaming (1 to port, 1 to starboard) ■ ■ 	<ul style="list-style-type: none"> ■ ■ ■ 2 Double jammers, in coaming + 1 Single clutch, on the coachroof ■ ■

IN-MAST FURLER PACK

- The standard Dacron C-breeze self-tacking jib is retained.
- Anodised aluminium ⁹/₁₀th in-mast furler (Selden), 2 sets of spreader bars
 - Dacron C-breeze cross-cut mainsail

PERFORMANCE PACK

FIRST LINE ALU PACK (incompatible with the rigging packs)

Requires standard classic mast and a trim level

Boast supplied without sails - Performance sails optional

- Polyester bowsprit with integrated anchoring gear and bobstay (for Code 0 and asymmetric spinnaker)
- Flatdeck genoa furler
- Additional jammers: 1 Double jammer on coaming to port and starboard for mainsail sheet, genoa sheet, adjustment of Genoa sheet traveller (control line) + 1 Triple jammer on the roof for spinnaker halyard/code 0
- Performance, Punch, Dyneema core running rigging (Halyards: Mainsail, Genoa, Code 0, Asymmetrical spinnaker)
- Genoa sheet 3D adjustment rings on the roof
- Asymmetrical spinnaker rigging / Code 0 (sheets, Blocks, Halyards)
- German system (Two-way mainsheet at the helm station)
- 1 Starboard manual (H35.2 STA) rigging winch + Cadet Grey halyard bag
- 2 Manual (H40.2 STA) genoa sheet winches + Aluminum "Speed Grip" winch handle + Winch handle holder
- Performance hull graphics (Red sticker)

OPTIONS

HULL - DECK - COCKPIT

- Pearl grey gel-coat
- Iro-Deck slatted cockpit floor
- Synthetic covering for bottom of cockpit (flexible, removable covering with press stud attachment, imitation teak slats)
- "Luxe" polyester/wood cockpit table, Stainless steel handrail, 1 Waterproof USB socket for charging smartphone or using LED lighting (lighting not supplied), Central storage (15 L / 4 US Gal), Cup holders - requires Confort trim level
- Cover for "Luxe" cockpit table (Cadet Grey)
- Steering wheels covers (Cadet Grey)
- "Luxe" sprayhood (Cadet Grey)
- Bimini "Luxe" (Cadet Grey)
- Cockpit seats Dolce 51
- 12 V tunnel bow thruster (Side Power) + Dedicated batteries and charger (50 Amp - 12 V)
- 2 Mooring cleats on transom
- 3 folding blades propeller
- Mooring kit:
 - Delta 16 kg/32 lbs anchor (galvanized steel)
 - Chain (diameter: 10 mm / $\frac{3}{8}$ " - Length: 28 m / 92')
 - Line (diameter: 18 mm / $\frac{11}{16}$ " - Length: 40 m / 131')
 - 6 Fenders - M (diameter: 200 mm / 8" - Length: 635 mm / 2'1")
 - 4 Moorings lines (diameter: 16 mm / $\frac{5}{8}$ " - Length: 12 m / 39'4")
- Electric windlass (1 000 W) - Remote control (not compatible with Family trim level)
- Windlass control with chain counter in cockpit
- Access openings to port and starboard
- Outboard engine bracket (not compatible with Family trim level)
- Shore freshwater supply
- Stand + support plates on the hull (option required for grounding the retractable keel version)
- Gunwale on hull

NAVIGATION ELECTRONICS: RAYMARINE

- 1 9" Axiom+ screen on starboard console in lieu of 7"
- S100 Wireless autopilot remote control
- 700 AIS

RIGGING - SAILS

- Performance sail pack (implies pack First Line Alu): High resistance Dacron square-topped mainsail, 4 battens, Natural UV protection, cross cut + Genoa sheet on Flatdeck furler, high resistance Dacron, Natural UV protection, cross cut
- Code 0 on furler for mast with in-mast furling or standard mast, Lamine 15 Optic 2 (Light grey) - implies pack Downwind or First Line pack
- Natural color Lazy bag + Lazy-jacks
- Self-tacking jib rigging (track and traveller) - implies pack Upwind or Upwind & Downwind pack

WINCHES

- 1 Port electric primary winch (H35.2 STAEH), instead of standard

INTERIOR EQUIPMENT

LAYOUT VERSIONS

- 2 cabins 1 head version
- 3 cabins 1 head version

AMBIANT

- Interior woodwork: Sand oak alpi
- Brown oak laminated floors (only with sand oak alpi joinery)
- Internal upholstery according to color chart
- Macadamia padding upholstery: Salon & Cabins
- Companionway steps made from mixed wood on floor

ON BOARD COMFORT EQUIPMENT

- Salon table upgrade: solid Alpi wood around the edge
- Sea water foot pump, in galley (with cool box drainage function)
- Additional fresh water tank (130 L / 34 US Gal) below aft port side cabin bed
- 16 000 BTU air conditioning full boat (only for use via shore power supply) - Not compatible with 3 cabin version
- 8 000 BTU air conditioning salon and front cabin (only for use via shore power supply)
- 8 000 BTU Autonomous air conditioning on Lithium battery in forward cabin and salon , operating duration: 3 hours on battery, useful when at anchor + recharging and use of motor or shore power (12 V - 115 V) (Not compatible with heating, inverter, lithium battery options - required Comfort or Family trim level)
included:
 - 1 Dedicated 12 V/115 V - 2 000 W inverter (this inverter does not allow the onboard comfort options)
 - 3 Lithium batteries (90 Amp)
 - 1 60 Ah service battery charger (replacing the 40 Ah charger for the trim level)
 - Navicolor 3.5" screen for displaying the battery charge level
- Diesel heater "air pulse"
- 1 12 V / 115 V inverter - 2 000 W
- Quiet Flush seawater electric toilet
- Shore freshwater supply
- 1 90 Ah lithium battery replacing the 2 AGM100 Ah service batteries + Navicolor 3.5" screen for displaying the battery charge level (required Comfort or Family trim level).
The lithium batteries can be used in exactly the same way as the greater number of AGM batteries that they replace. This technology allows 100% of the battery capacity to be used compared with 75% for the AGM batteries. The engine battery is still AGM.
- Tableware Kit - 6 people
- Fans in the salon and cabins (not compatible with Family trim level)